

NDCRS ARCHITECTURAL SITE FORM

PAGE 1

SITS# 32 SN 803

SITE IDENTIFICATION

Field Code Sinclair Township School Site Name Sinclair Township School

Map Quad Jamestown
Map Quad _____

LTL	TWP	<u>139</u>	R	<u>64</u>	SEC	<u>1</u>	QQQ	<u>8</u>	QQ	<u>8</u>	Q	<u>5</u>
LTL	TWP	_____	R	_____	SEC	_____	QQQ	_____	QQ	_____	Q	_____
LTL	TWP	_____	R	_____	SEC	_____	QQQ	_____	QQ	_____	Q	_____
LTL	TWP	_____	R	_____	SEC	_____	QQQ	_____	QQ	_____	Q	_____

UTM _____ N ZONE _____
UTM _____ E NAD 1927 _____ NAD 1983 _____

Subsection:
1 = N $\frac{1}{2}$
2 = E $\frac{1}{2}$
3 = S $\frac{1}{2}$
4 = W $\frac{1}{2}$
5 = NE $\frac{1}{4}$
6 = SE $\frac{1}{4}$
7 = SW $\frac{1}{4}$
8 = NW $\frac{1}{4}$

City: Jamestown

Street Number: 404

Street Name: Louis L'Amour Lane

Urban Legal Description: _____

SITE DATA

Total # **Architectural** Features: 1

Fieldwork Date: 11/3/2014

Reconnaissance Survey Intensive Survey

Project Title & Supervisor:
Country Schoolhouse Project

Report Title & Author(s): _____

Additional Information: _____

SHSND USE
 Area of Significance 2 Ecozone 18 Verified Site 1 CR Type 2
 Area of Significance _____ Ecozone _____ Non-Site _____
 Area of Significance _____

Recorded By Kathy Wilner Date Recorded 2/21/2015
(First Name & Last Name) (mm/dd/year)

Instructions to complete a digital version of this form: (1) Download a copy to your hard drive; (2) Open the saved blank copy; (3) Fill out the form; (4) Use the Save As command to rename the form appropriately and save; (5) Print and submit to SHSND.

NDCRS ARCHITECTURAL SITE FORM PAGE 2—Feature Data

Field Code Sinclair Township SchoolSITS# 32 SN

Complete one Page 2 for each architectural feature at the site.

Architectural Feature # 1Construction Date 1910Feature Type 9Condition 7Feature Date 3Context 7Plan Shape 5Structural System 25Primary Exterior 26Style Other Style

Original Owner's Ethnicity _____

Secondary Exterior _____

Architect/Builder _____

Other Information:

Foundation Concrete Block Stories 1Roof/Cornice GableWindow 2 pane, double hungDating Method(s): Frontier Village records

Feature Preservation Recommendation(s) (Check all that apply):

 Individual nomination Contributes to a potential district No nomination potential Will not contribute to a district Potential district—feature would be a contributing element if other properties constitute a district Thematic nomination potential Component of a historic site or landscape

Moved (specify all applicable choices)—a) relocation occurred within a historic period; b) recreates original site, orientation, landscape, & spatial relationships; c) compatible in context with neighboring structures; d) relocation has damaged eligibility

 Historical associations require further investigation

Recorded By Kathy Wilner Date Recorded 2/21/2015
(First Name & Last Name) (mm/dd/year)

Instructions to complete a digital version of this form: (1) Download a copy to your hard drive; (2) Open the saved blank copy; (3) Fill out the form; (4) Use the Save As command to rename the form appropriately and save; (5) *Print* and submit to SHSND.

NDCRS ARCHITECTURAL SITE FORM
PAGE 3—Feature DataField Code Sinclair Township SchoolSITS# 32 SN**Complete a Page 3 for each feature.****1. Feature Description, Integrity, Eligibility:**

The feature is a simple, wood framed one room school sitting on concrete blocks. The school was moved to Frontier Village in Jamestown in 1961 from Sinclair Township. The roof is covered with old asphalt shingles. There is a brick chimney at the south end of the peak of the roof. The eaves have enclosed soffits. The building measures 18 1/2 feet east to west and 28 1/2 feet north to south.

A wide header runs under the eaves at the peak ends as well as along both sides. The remainder of the siding is 6 inch wood lap with 4 inch corner trim. The paint is in very good shape. There are three 2 pane, double hung windows on the east wall as well as three more on the west wall. The glass is intact. The school is well maintained and furnished. There is a 5 panel wood entry door with a small glass transom above it. The floor is tongue and groove hardwood. The walls are lathe and plaster and all painted white with wainscot. The blackboard is on the south wall. The stove sits about 2/3 of the way to the north with a long pipe running to the chimney at the south end. There is electricity to the school, light fixtures hang in the school room.

Recorded By Kathy Wilner Date Recorded 2/21/2015
(First Name & Last Name) (mm/dd/year)

Instructions to complete a digital version of this form: (1) Download a copy to your hard drive; (2) Open the saved blank copy; (3) Fill out the form; (4) Use the Save As command to rename the form appropriately and save; (5) *Print* and submit to SHSND.

**NDCRS ARCHITECTURAL SITE FORM
PAGE 4—SITE DESCRIPTION**

Field Code Sinclair Township School

SITS# 32 SN

Complete one Page 4 for the entire site.

2. Owner's Contact Information:

Frontier Village
404 Louis L'Amour Lane
Jamestown ND 58401

3. Access (to rural areas):

Take Jamestown exit for Highway 281 and turn right to drive about 4-5 blocks to the north. Look for Louis L'Amour Lane, turn right and follow that road to the Villiage.

4. Site Area (ft²): _____

5. Description of **SETTING**:

This school sits in a frontier village with buildings three sides and a hill to the south.

Recorded By Kathy Wilner Date Recorded 2/21/2015
(First Name & Last Name) (mm/dd/year)

Instructions to complete a digital version of this form: (1) Download a copy to your hard drive; (2) Open the saved blank copy; (3) Fill out the form; (4) Use the Save As command to rename the form appropriately and save; (5) Print and submit to SHSND.

**NDCRS ARCHITECTURAL SITE FORM
PAGE 5—SITE DESCRIPTION**

Field Code Sinclair Township School

SITS# 32 SN

6. Summary of ALL Site Features & Evaluation of Significance:

7. References/Comments:

Kathy Wilner
366 43rd Ave SE
Bowdon ND 58418

Recorded By Kathy Wilner Date Recorded 2/21/2015
(First Name & Last Name) (mm/dd/year)

Instructions to complete a digital version of this form: (1) Download a copy to your hard drive; (2) Open the saved blank copy; (3) Fill out the form; (4) Use the Save As command to rename the form appropriately and save; (5) Print and submit to SHSND.



North Side

Sinclair Township School

11/3/2014

Kathy Wilner

SN

West Side





East Side

Sinclair Township School

11/3/2014

Kathy Wilner

SN

South Side



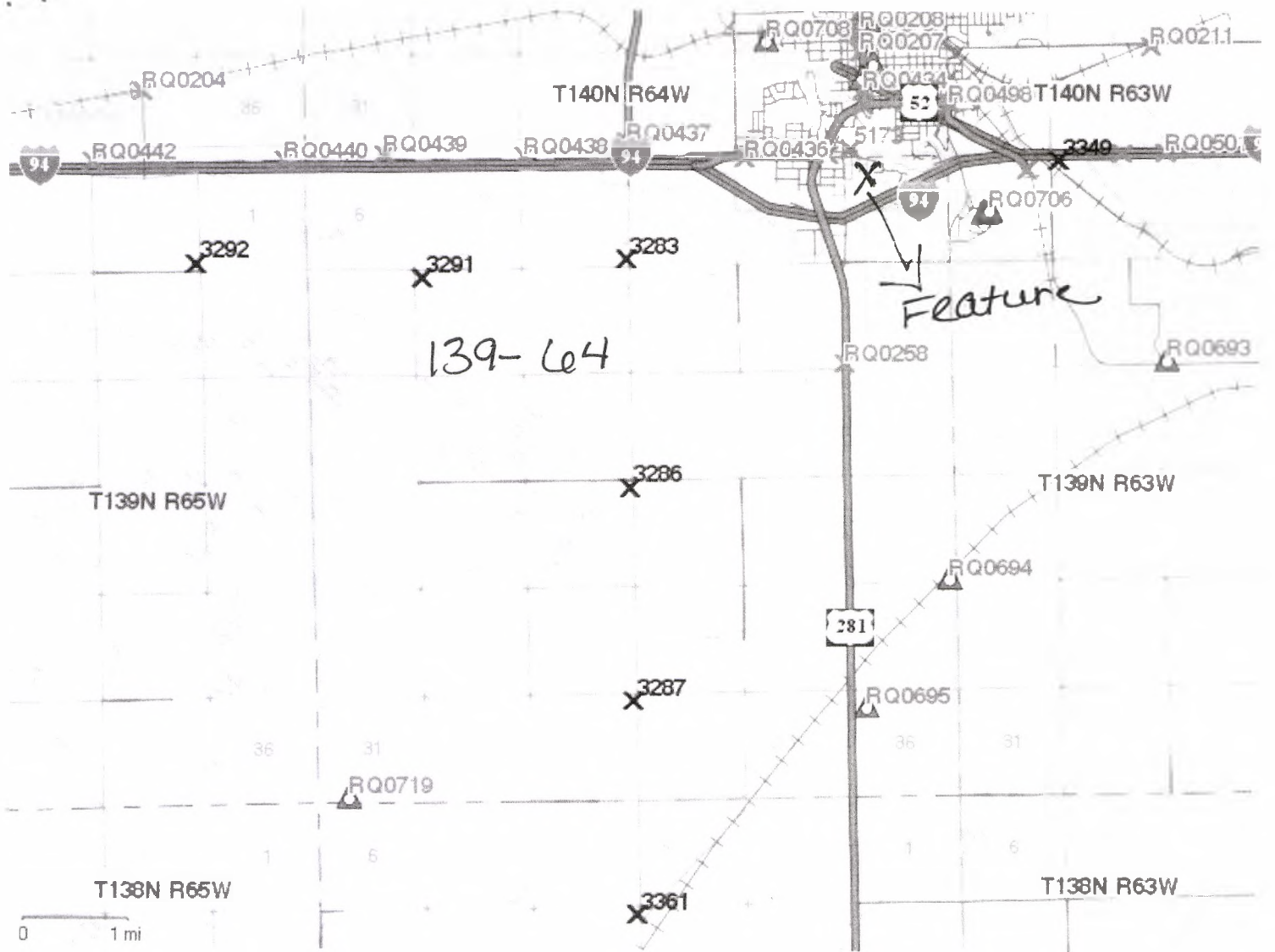

Sinclair Township School 11-3-2014 Kathy Wilner SN